











CRT offers a wide range of high precision tools with designs optimized for Green Stage Ceramic Machining.

Long standing experience in high Precision tool manufacturers coupled with in-depth application experience, enables us to offer tools to obtain close machining tolerances, improved surface quality and reduced rejections of advanced ceramics.

## STANDARD TOOL RANGE

				
Endmills with Corner Radius	Square Flute Endmills	Ball Ended Drills	Coolant Hole Drills	Drills With Long Flute
0.20 - 20.00	0.050 - 20.00	Starting From Ø0.20	0.80 - 20.00	Starting From 0.10 L/D ≤ 100

## TOOLS FOR CUSTOMER DRAWINGS

				
Ball Endmills	Taper Drills	Drills with special angle	Step Drills	Combination Drills
Special Ball Forms	Different Angles	Acute angles 60°/90°	Custom built	Front Helical + Step flat
0.10 - 20.00	0.20 - 20.00	0.10 - 20.00	0.10 - 10.00	0.10 - 20.00

## PRODUCT RANGE

### Drills

Micro Drills ≥0.020mm (20μ)  
**XXL** Micro Drills  
 Ball Ended Drills  
 Coolant Hole Drills  
 Drill with Long Flute ≤ L/D 100  
 Multi Step Drills

### Endmills

Square Endmills  
 Ballnose Endmills  
 Corner Radius Endmills  
 Multi Step Endmills  
 Taper Endmills

### Long Approach / XXL

Square Endmills with long Approach  
 Ballnose Endmills with Long Approach  
 Corner radius Endmills with Long Approach

\*All dimensions are in mm

Available Coatings



QUALITY • PRECISION • CONSISTENCY

 [www.carbiderelatedtech.com](http://www.carbiderelatedtech.com)  
 [mlee@carbiderelatedtech.com](mailto:mlee@carbiderelatedtech.com)

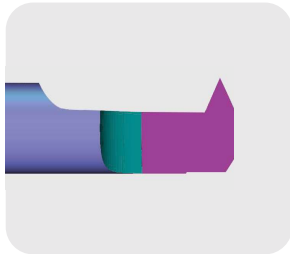
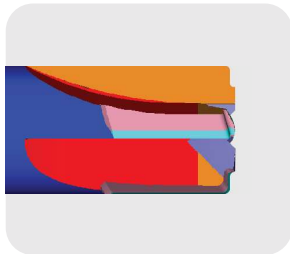
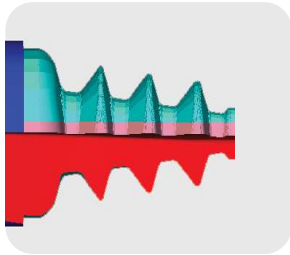
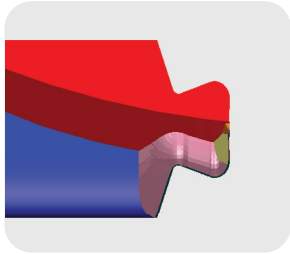
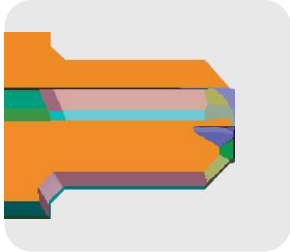
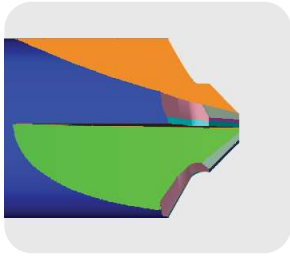

**Materials to Machine Green Stage**

- Tungsten Carbide
- Ceramic
- Zirconia
- Graphite
- Alumina
- MACOR<sup>®</sup>

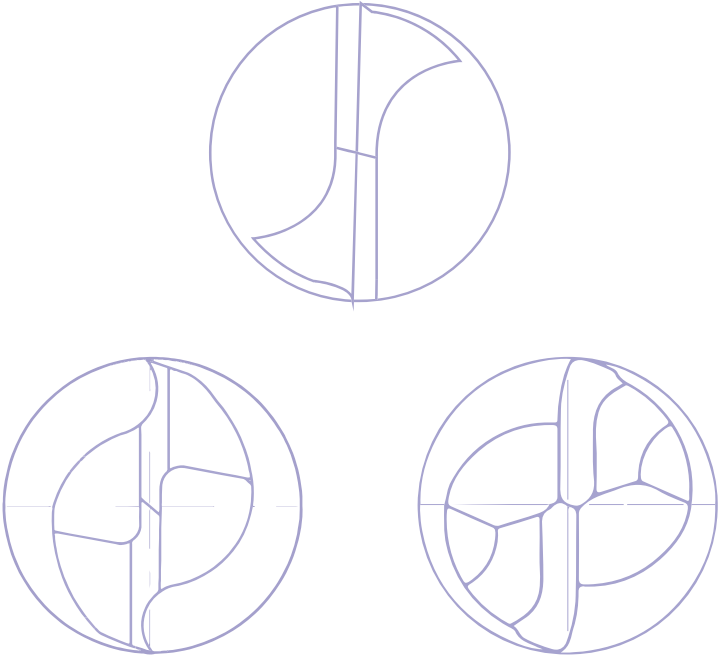
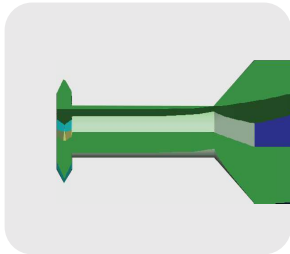
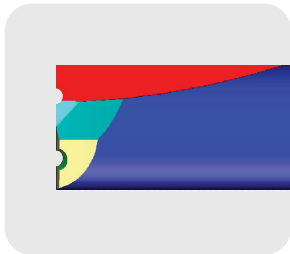
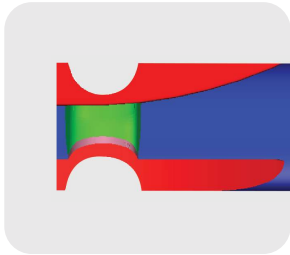
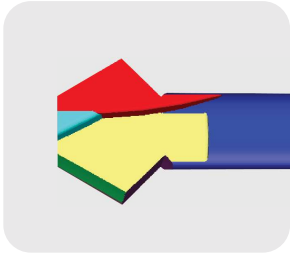
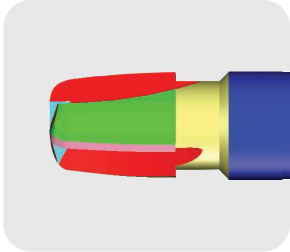
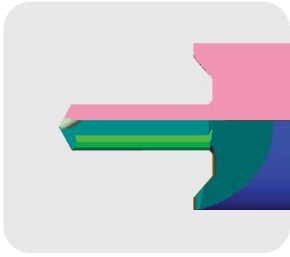

**Features**

- Long Tool Life
- Consistent Performance
- Customized Solutions
- Greater Process Efficiency

**Customised Tools**

